



## PLX-Pure Lead High Rate

### PLX12-500 (12V500W)

#### Specifications

Rated Voltage	12V	
Nominal Rate ( $W_{15}$ , 1.67V/cell)	500W	
Nominal Capacity ( $C_{10}$ , 1.80V/cell)	125Ah	
Dimension	Length	340.9±2mm (13.42 inches)
	Width	170±2mm (6.69 inches)
	Container Height	273.2±2mm (10.76 inches)
	Total Height	275.7±2mm (10.85 inches)
Approx. Weight	41.7 Kg (91.9 lbs)	
Terminal	T8(M6)	
Container Material	PC-ABS flame retardant jar and cover to UL94 V-0	
Max. Discharge Current	1500A	
Short Circuit Current	2900A	
Internal Resistance (25°C)	Approx. 3.40mΩ(Fully charged)	
Operating Temp.Range	Discharge	-40 ~ 65°C (-40 ~ 149°F)
	Charge	0 ~ 54°C (32 ~ 129°F)
	Storage	-20 ~ 40°C (-4 ~ 104°F)
Nominal Operating Temp. Range	25±3°C (77±5°F)	
Max.Charging Current(25°C)	37.5A	
Charge voltage(25°C)	Float	13.62V
	Temp. Coefficient	-3mV/cell/°C
	Equalization	14.1~14.4V
Effect of temp. to Capacity	40°C (104°F)	103%
	25°C (77°F)	100%
	0°C (32°F)	86%
Self Discharge	PLX series batteries can be stored up to 24 months at 25°C(77°F), For higher temperatures the time interval will be shorter.	
	Battery needs to be given a freshening charge when the OCV approach 2.10V/cell or when the maximum storage time is reached, whichever occurs first.	



#### Layout

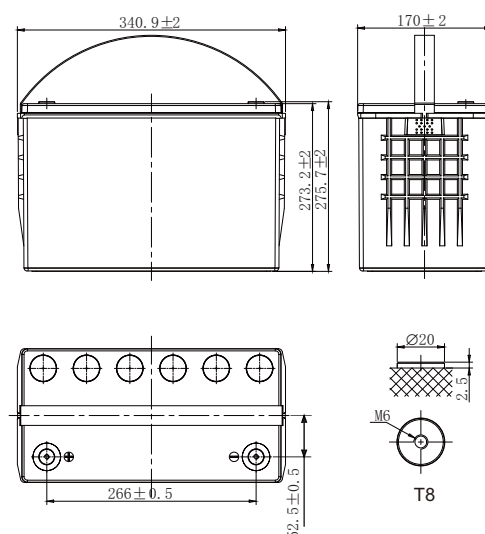

#### Constant Current Discharge (Amperes) at 25 °C (77° F)

F.V/Time	5min	10min	15min	20min	30min	45min	1h	2h	3h	4h	5h	8h	10h	20h
1.85V/cell	321.0	249.6	196.5	174.9	140.9	104.5	85.2	47.6	35.3	27.3	23.2	15.9	12.3	6.38
1.80V/cell	361.3	287.7	218.9	191.1	150.5	109.8	88.6	49.8	36.9	28.4	24.3	16.4	12.5	6.50
1.75V/cell	395.0	315.0	237.2	203.9	160.2	112.9	91.1	51.2	37.8	29.2	24.8	16.6	12.7	6.58
1.70V/cell	425.6	340.6	252.4	214.5	166.3	117.0	94.6	51.9	38.6	29.7	25.2	16.8	12.8	6.63
1.67V/cell	475.0	358.8	266.1	222.8	173.1	121.6	96.7	52.9	39.0	30.1	25.4	17.0	12.9	6.68
1.60V/cell	513.4	364.8	275.1	229.0	176.4	123.4	98.3	53.7	39.5	30.4	25.7	17.2	13.0	6.73

#### Constant Power Discharge (Watts/cell) at 25 °C (77° F)

F.V/Time	5min	10min	15min	20min	30min	45min	1h	2h	3h	4h	5h	8h	10h	20h
1.85V/cell	859.3	598.1	476.4	372.8	290.0	216.6	170.5	95.6	71.4	55.4	47.3	32.5	25.2	13.2
1.80V/cell	860.96	617.1	477.4	374.3	296.7	217.6	176.3	99.4	74.0	57.3	49.2	33.4	25.6	13.4
1.75V/cell	866.0	634.2	480.9	395.7	312.8	221.8	179.9	101.5	75.5	58.5	50.0	33.7	25.8	13.5
1.70V/cell	860.9	646.0	481.4	411.8	321.5	227.5	185.4	102.3	76.4	59.1	50.4	33.9	26.0	13.5
1.67V/cell	890.0	675.4	500.0	425.2	332.7	235.0	188.4	103.6	76.8	59.6	50.6	34.1	26.1	13.6
1.60V/cell	897.6	680.3	516.3	432.9	335.8	236.6	189.8	104.2	77.1	59.7	50.6	34.1	26.1	13.6



## PLX-Pure Lead High Rate PLX12-500 (12V500W)

### Applications

- UPS
- Emergency lighting
- Emergency power supply
- Electrical starting
- Power tools

### General Features

- 15 years design life(25°C)
- Premium ABS+PC jar & covers, Flame Retardant to UL94 V-0
- High-rate performance, high energy density
- High quality AGM separators minimize electrical resistance to allow high current discharging properties

### Standards

- Classified as "Very Long Life" according to Eurobat
- CE, UL Certified
- Manufactured in Leoch@IATF16949, OHSAS 18001,ISO 9001 and ISO 14001 certified production facilities

### Discharge Characteristics

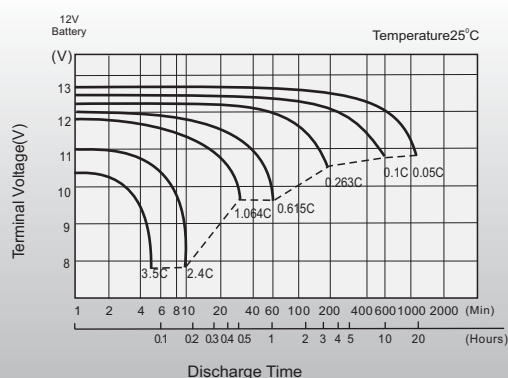

### Float Charging Characteristics

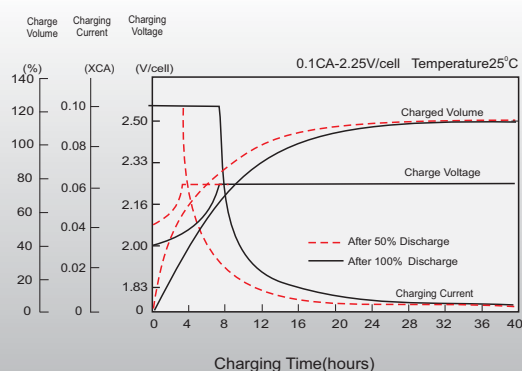

### Effects of Temperature on Discharging Time

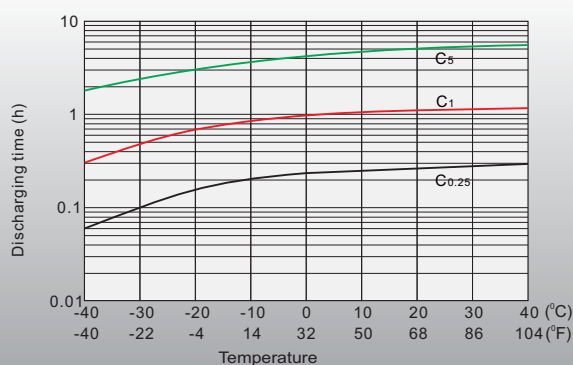

### Float Life

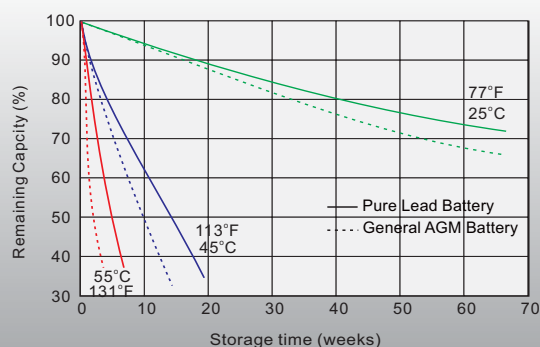

## Sales Offices Worldwide

### Marstech Systems Pte Ltd

Add:Block 24,Sin Ming Lane #05-107 Midview City, Singapore  
Tel : +65 66775598  
www.marstech.com.vn